

Table 1: Soil Analytical Results – Residential SWHS Exceedances

Analyte	Dieldrin	Arochl 1254	PCBs, Total	4-Chloro aniline	Benz(a) fluoranthene	Benz(a) pyrene	Indeno (1,2,3-cd) pyrene	Arsenic	Lead	Mercury	Chloro-benzene	Tetrachloroethene (PCE)	Ethyl-benzene	Xylenes, Total	1,2,4-Trichloro-benzene	1,4-Dichloro-benzene	1,2-Dichloro-benzene
Res. Direct Contact (0-15")	1.3	4.4	NC	93	3.5	0.58	3.5	12	500	35	960	770	180	1900	130	40	3800
Res. Soil to Groundwater	0.13	75	NC	0.47	26	46	1500	29	450	10	10	0.5	70	1000	8.4	10	60
Location	Sample ID	Sample Depth	Date	mg/kg	mg/kg	mg/kg	mg/kg	mg/kg	mg/kg	mg/kg	mg/kg	mg/kg	mg/kg	mg/kg	mg/kg	mg/kg	mg/kg
Sprayfield #4	SF4-2	0-0.5	10/8/2020	0.0318	0.0928	0.152	ND(0.21)	0.038 J	ND(0.17)	ND(0.17)	5.3	626	2.23	ND(0.00071)	ND(0.00071)	ND(0.0014)	ND(0.0028)
Sprayfield #4	SF4-2N	0-0.5	11/13/2020	-	-	-	-	-	-	-	515	-	-	-	-	-	-
Sprayfield #4	SF4-2E	0-0.5	11/13/2020	-	-	-	-	-	-	-	574	-	-	-	-	-	-
Sprayfield #4	SF4-11	0-0.5	2/19/2020	-	-	-	-	-	-	-	-	-	-	-	-	-	-
Sprayfield #5	SF5-1	0-0.5	10/14/2019	-	-	-	-	-	-	-	7.24	494	4.3	-	-	-	-
Sprayfield #5	SF5-2	0-0.5	10/14/2019	ND(0.0013)	1.19	2.62	ND(0.22)	0.084 J	ND(0.17)	0.055 J	9.01	653	6.67	ND(0.00055)	ND(0.00055)	ND(0.0011)	ND(0.0022)
Sprayfield #5	SF5-4	0-0.5	10/14/2019	ND(0.0012)	1.32	4.24	ND(0.21)	0.14	0.066 J	0.099 J	6.93	931	3.86	ND(0.00056)	ND(0.00056)	ND(0.0011)	ND(0.0022)
Sprayfield #7	SF7-12	0-0.5	10/7/2020	ND(0.0013)	0.083 J	0.178	ND(0.21)	1.4	0.55	6.66	60.1	4.58	ND(0.00062)	ND(0.00062)	ND(0.0012)	ND(0.0024)	
Trench - Main	MTP-1-3.5	3.5-4.0	1/29/2020	-	1.21	2.39	ND(1.9)	6.8	8.7	2.76	1000	0.59	-	-	-	-	-
Trench - Main	MTP-3-3.5	3.5-4.0	1/29/2020	-	0.748	1.94	0.046 J	ND(1.8)	ND(1.8)	2.74	3040	8.51	-	-	-	-	-
Trench - Main	MTP-5-3.5	3.5-4.0	1/29/2020	-	3.23	4.38	ND(0.26)	0.19	0.14 J	0.24	12.6	1150	3.64	ND(0.0011)	ND(0.0022)	ND(0.0044)	
Trench - Main	TR195-73.5-2	2.0-2.5	10/29/2019	0.119	2.92	4.76	ND(0.73)	0.46	0.19	0.33	12.8	128	10.4	ND(0.0011)	ND(0.0022)	ND(0.0044)	
Trench - Main	TR267-118.6	6.0-6.5	10/29/2019	ND(0.0177)	2.75	3.31	8.2	ND(1.4)	ND(1.8)	8.67	443	7.33	61	ND(4.3)	520	280	220
Trench - Main	TR267-85.2	2.0-2.5	10/29/2019	0.167	1.47	2.05	1.6	0.2	ND(0.73)	0.13 J	5.52	816	28	ND(0.087)	ND(0.17)	0.2	2.9
Trench - Main	TR289-26.2	2.0-2.5	2/4/2020	ND(0.0135)	0.938	0.938	ND(1.2)	ND(7.3)	ND(0.8)	3.4	1580	2.03	0.29	2.9	17	30	3.1
Trench - Main	TR318-14.2	2.0-2.5	10/30/2019	ND(0.0013)	1.6	1.6	ND(0.63)	0.2	ND(0.5)	0.2	85.4	4894	8.56	ND(0.0006)	0.0055	ND(0.0012)	ND(0.0024)
Trench - Main	TR359-91.5	5.0-5.5	10/30/2019	ND(0.0504)	1.21	1.21	7.4	ND(7.6)	ND(10)	ND(10)	17.3	2580	6.07	12	20	22	24
Repair Shop	TP-10-0.5	0.5-1	11/17/2020	-	1.25	1.25	-	0.12	ND(0.33)	0.11	1.5	7960	0.69	ND(0.00059)	ND(0.00059)	ND(0.0012)	ND(0.0024)

Notes:  
 All values are listed in milligrams per kilogram (mg/kg), equivalent to parts per million (ppm).  
 NC = No Criteria  
 ND = Not Detected above laboratory method detection limits (MDLs)  
 (0.16) = Laboratory reporting limit (RL)  
 J = Estimated value above the MDL but below the limit of quantitation  
 RL = Laboratory Reporting Limit  
 MDL = Laboratory Method Detection Limit  
 - = Not Analyzed  
 PADEP = Pennsylvania Department of Environmental Protection  
 Res. = Residential  
 rSVsoil = Residential Vapor Intrusion Screening value for soil  
 Red Bold values exceed the Res. Direct Contact (0-15) or Res. Soil to Groundwater Statewide Health Standards  
 Highlighted values exceed the rSV so

Table 2: Groundwater Analytical Results  
 Gray Brother's Property  
 1025 Worthington Rd. Exton, PA

WELL ID	MW-18	MW-10	MW-35	MW-3D	MW-4D	MW-4S	MW-48	MW-4D	MW-7S	MW-7D	MW-9S	MW-9D	MW-10S	MW-11D	MW-12S
SCREEN INTERVAL / BOREHOLE SAMPLE DEPTH	23.5-28.5 / 5	15 / 5	39-50 / 15	85 / 15	85 / 15	85 / 15	85 / 15	85 / 15	85 / 15	85 / 15	85 / 15	85 / 15	85 / 15	85 / 15	85 / 15
COLLECTION DATE	01/25/2020	01/25/2020	01/25/2020	01/25/2020	01/25/2020	01/25/2020	01/25/2020	01/25/2020	01/25/2020	01/25/2020	01/25/2020	01/25/2020	01/25/2020	01/25/2020	01/25/2020
ANALYTE	mg/L	mg/L	mg/L	mg/L	mg/L	mg/L	mg/L	mg/L	mg/L	mg/L	mg/L	mg/L	mg/L	mg/L	mg/L
Chloride	ND (1)	38 (1)	ND (1)	112 (1)	112 (1)	ND (1)	112 (1)	112 (1)	ND (1)	ND (1)	53 (1)	53 (1)	53 (1)	ND (1)	112 (1)
Dis-1,2 Dichloroethene	5 (0)	NC	5 (0)	1400 (20)	1500 (25)	ND (0.5)	200 (2.5)	200 (2.5)	ND (0.5)	13 (0.5)	7.1 (0.5)	50 (0.5)	ND (0.5)	14 (0.5)	2.4 (0.5)
Dieldrin	5 (5)	8 (2.5)	5 (5)	446 (20)	446 (20)	ND (0.5)	100 (0.5)	100 (0.5)	ND (0.5)	17 (0.5)	2.8 (0.5)	17 (0.5)	ND (0.5)	11 (0.5)	11 (0.5)
Endrin	119 (0.9)	0.5 (0.5)	0.5 (0.5)	0.5 (0.5)	0.5 (0.5)	ND (0.5)	0.5 (0.5)	0.5 (0.5)	ND (0.5)	0.5 (0.5)	0.5 (0.5)	0.5 (0.5)	ND (0.5)	0.5 (0.5)	0.5 (0.5)

Notes:  
 µg/L = micrograms per liter  
 NC = No Criteria  
 ND = Not Detected above laboratory method detection limits (MDLs)  
 J = Estimated value above the MDL but below the limit of quantitation  
 Conc. = Laboratory reported concentration  
 Q = Laboratory Qualifier  
 RL = Laboratory Reporting Limit  
 MDL = Laboratory Method Detection Limit  
 - = Not Analyzed  
 PADEP = Pennsylvania Department of Environmental Protection  
 PQL = Practical Quantitation Limit  
 rSVsoil = Act 2 Residential Vapor Intrusion Screening Value for Groundwater  
 rSVgw = Residential Vapor Intrusion Screening Value for Groundwater  
 Red Bold values exceed rSV gw  
 Highlighted values exceed the rSV gw

MANAGEMENT OF CONTAMINATED MEDIA

- SOIL WITH CONTAMINANTS REPORTED AT LEVELS THAT EXCEED THE PENNSYLVANIA DEPARTMENT OF ENVIRONMENTAL PROTECTION (PADEP) RESIDENTIAL STATEWIDE HEALTH STANDARDS (SWHS) HAS BEEN ENCOUNTERED OR SUSPECTED ON PORTIONS OF THE SUBJECT PROPERTY. CONTAMINATED SOIL WILL BE REMEDIATED AS AN INITIAL SEQUENCE OF CONSTRUCTION. PLEASE REFER TO THE REMEDIATION INVESTIGATION REPORT / CLEANUP PLAN DEVELOPED FOR THIS PROPERTY, WHICH OUTLINES PROPOSED REMEDIAL ACTIVITIES.
- ENCLOSURES OF SOIL REMEDIATION ACTIVITIES WILL BE CONFINED TO THE FIELD AND CLEARLY LABELED AND IDENTIFIED. CONTAMINATED SOIL BARRIERS WILL BE PLACED AROUND THE DOWNGRADIENT EDGE OF THE REMEDIATION AREA TO PREVENT THE SPREAD OF SOIL. THE LOCATION OF SOIL BARRIERS WILL BE IDENTIFIED ON THE REMEDIATION PLAN. THE LOCATION OF SOIL BARRIERS WILL BE IDENTIFIED ON THE REMEDIATION PLAN. THE LOCATION OF SOIL BARRIERS WILL BE IDENTIFIED ON THE REMEDIATION PLAN.
- RESIDENTIAL SIGNS AT EACH REMEDIATION AREA, THE EXCAVATION BARRIERS SHALL BE REMOVED. FILTER SOCKS USED AT THE EXCAVATION AREAS SHALL BE MANAGED WITH THE CONTAMINATED SOIL.
- TEMPORARY STOCKPILES OF CONTAMINATED SOIL MAY BE NECESSARY DURING REMEDIAL SOIL EXCAVATIONS. TEMPORARY STOCKPILES WILL BE COVERED BY TARP OR PLASTIC SHEETING AT THE TIME OF LAND BANK STOCKPILES SHALL BE CLEARLY LABELED WITH THEIR STATUS (E.G. PENDING CHARACTERIZATION AND/OR REMEDIATION) FOR DISPOSAL AS NON-HAZARDOUS (CEN) AND THE LABELING MUST BE MAINTAINED UNTIL THE FINAL REUSE OR DISPOST OF MATERIAL IS COMPLETED. DROPPED SOIL SHALL BE CONTROLLED THROUGH THE INSTALLATION AND MAINTENANCE OF BARRIERS. THE LOCATION OF CONTAMINATED MATERIALS SHALL BE IN COMPLIANCE WITH LOCAL, STATE AND FEDERAL REGULATIONS, WHICH WILL BE OBTAINED BY THE CONTRACTOR AND THE PROPERTY OWNER.
- IF THE LOCATION OF THE IMPACTED SOILS THAT ARE TO BE REMOVED IS IN ACCORDANCE WITH THE DEPARTMENT'S SOIL WASTE MANAGEMENT REGULATIONS AT 25 PA CODE 2601 ET SEQ. 2711 ET SEQ. AND 2811 ET SEQ.
- NO EXCAVATED MATERIALS WILL BE REMOVED FROM THE SUBJECT PROPERTY WITHOUT THE ADVANCE NOTICE OF THE OWNER. MATERIALS THAT ARE EXPORTED FROM THE SUBJECT SITE MUST MEET THE REQUIREMENTS OF THE SWMA AND/OR MANAGEMENT OF FILL POLICY.
- CONTAMINATED GROUNDWATER HAS BEEN IDENTIFIED FOR REMEDIATION. CONTAMINATED GROUNDWATER REMOVED FROM THE GROUND DURING REMEDIATION WITHIN THE AREA IS NECESSARY SHALL BE PROPERLY DISPOSED OFF-SITE OR OTHERWISE MANAGED UNDER THE DIRECTION OF THE ENVIRONMENTAL ENGINEER.
- SHOULD ENVIRONMENTAL CONDITIONS BE IDENTIFIED THAT REQUIRE THE INSTALLATION OF CONTAMINATED GROUNDWATER REMEDIATION SYSTEMS, THE CONTRACTOR SHALL BE RESPONSIBLE FOR THE DESIGN, INSTALLATION AND MAINTENANCE OF SUCH SYSTEMS. APPROPRIATE ACTIONING WILL BE TAKEN AND DOCUMENTATION OF ACTIONS TAKEN TO ADDRESS THE CONCERN WILL BE FORWARDED TO THE PADEP UPON COMPLETION OF THE ACTIONS.

REMEDIATION DURING CONSTRUCTION NOTES

- AS REMEDIATION ON-SITE COMMENCES, THE ENVIRONMENTAL CONSULTANT SHALL OBSERVE THE OPERATIONS AND EVALUATE THE EXPOSED SOIL TO IDENTIFY POTENTIAL EXPOSURE PATHWAYS BY MEANS OF SURFACE RUNOFF OR DIRECT CONTACT. SHOULD CONTAMINATION EXPOSURE BE ENCOUNTERED, CONSTRUCTION MUST CEASE UNTIL CORRECTIVE PROCEDURES AND OPERATIONS CAN BE EMPLOYED TO ELIMINATE THE CONTAMINATION EXPOSURE.
- STORMWATER DISCHARGE LEAVING THE SITE SHALL BE VISUALLY MONITORED DURING CONSTRUCTION TO CONFIRM SUSPENDED SEDIMENTS ARE NOT BEING TRANSPORTED OFF-SITE AT UNACCEPTABLE LEVELS.

CONTAMINATED SITE INFORMATION:

- ALL WORK SHALL BE PERFORMED IN ACCORDANCE WITH OSHA OSHA-OSHA AND THE HEALTH AND SAFETY REQUIREMENTS OF THE OWNER. THE CONTRACTOR SHALL BE RESPONSIBLE FOR MAINTAINING EXCAVATIONS DURING THE PERIOD OF CONSTRUCTION. CONTROL OF GROUNDWATER SEEPAGE AND STORMWATER RUNOFF INTO EXCAVATIONS SHALL BE SOLELY THE RESPONSIBILITY OF THE CONTRACTOR.
- THIS SITE IS CLASSIFIED AS A BROWNFIELD SITE AND A REMEDIAL INVESTIGATION REPORT AND CLEANUP PLAN (RI/CP) IS LAND RECYCLING PROGRAM HAS BEEN PREPARED. THE CONTRACTOR IS ADVISED TO BECOME THOROUGHLY FAMILIAR WITH THE RI/CP, LATEST REVISIONS AND MUST REFER TO THE REMEDIATION DURING CONSTRUCTION NOTES PROVIDED ON THE SOIL, EROSION AND SEDIMENT POLLUTION CONTROL NOTES. THE OPERATOR SHALL REMOVE FROM THE SITE, RECYCLE OR DISPOSAL OF ALL BUILDING MATERIALS AND DEBRIS IN ACCORDANCE WITH THE DEPARTMENT'S SOIL WASTE MANAGEMENT REGULATIONS AT 25 PA CODE 2601 ET SEQ. 2711 ET SEQ. AND 2811 ET SEQ.
- REMEDIAL EFFORTS SHALL BE IN ACCORDANCE WITH THE APPROVED CLEANUP PLAN AND THE APPROVED DISCUSSION & SEDIMENTATION CONTROL PLAN.
- BASED ON EXISTING ENVIRONMENTAL DUE DILIGENCE INVESTIGATION REPORTS, NO ENVIRONMENTAL CONTAMINATION BEYOND THE DESIGNATED AREAS OF THE SITE ARE ANTICIPATED. HOWEVER, THE CONTRACTOR AND CONTRACTOR'S PERSONNEL SHALL NOTIFY THE SITE'S QUALITY ASSURANCE/QUALITY CONTROL OFFICER OF ANY UNUSUAL STAINS OR DISCOLORATION IDENTIFIED DURING EXCAVATION ACTIVITIES, AS WELL AS THE IDENTIFICATION OF ANY BARRIERS, MATERIALS, SIGNS OR TRENCHES.
- ANY OFF-SITE WASTE AND BORROW AREA MUST HAVE A EAS PLAN REVIEWED AND APPROVED BY THE CCOO PRIOR TO BEING ACTIVATED.
- THE CONTRACTOR AND CONTRACTOR'S PERSONNEL SHALL NOTIFY THE SITE'S QUALITY ASSURANCE/QUALITY CONTROL OFFICER OF ANY UNUSUAL STAINS OR DISCOLORATION IDENTIFIED DURING EXCAVATION ACTIVITIES, AS WELL AS THE IDENTIFICATION OF ANY BARRIERS, MATERIALS, SIGNS OR TRENCHES.
- THE SCHEDULE PORTIONS OF THIS PROJECT PLAN SHALL BE UNDER TAKEN IN CONSULTATION WITH LEFT CHRISTOPHER, P.C., LSPR OF GEO-TECHNOLOGY ASSOCIATES, INC. (484) 491-6112, OR OTHER QUALIFIED ENVIRONMENTAL PROFESSIONAL.
- THE ENVIRONMENTAL PROFESSIONAL WILL CONDUCT SAMPLING AND ANALYSIS IN ACCORDANCE WITH THE PENNSYLVANIA LAND RECYCLING AND ENVIRONMENTAL REMEDIATION STANDARDS ACT NECESSARY TO DOCUMENT ESTIMATION OF THE (DMS) FOR THE REMEDIATION SOILS.
- AS EXCAVATION PROCEEDS WITH THE REMEDIATION COMMENCES, THE CONTRACTOR SHALL OBSERVE THE OPERATIONS AND EVALUATE THE EXPOSED SOIL TO IDENTIFY POTENTIAL EXPOSURE PATHWAYS BY MEANS OF SURFACE RUNOFF OR DIRECT CONTACT. SHOULD CONTAMINATION EXPOSURE BE ENCOUNTERED, CONSTRUCTION MUST CEASE UNTIL CORRECTIVE PROCEDURES AND OPERATIONS CAN BE EMPLOYED TO ELIMINATE THE CONTAMINATION EXPOSURE.
- THE PERMITTEE IS RESPONSIBLE FOR ASSURING THAT ANY FILL MATERIAL USED AT THE SITE, WHETHER BROUGHT ONTO THE SITE OR GENERATED AT THE SITE, MEETS THE MANAGEMENT OF FILL POLICY. FILL MATERIALS OBTAINED FROM OR DISPOSED DURING CONSTRUCTION AND/OR REMEDIATION ACTIVITIES SHALL BE MANAGED IN ACCORDANCE WITH THE SOIL WASTE MANAGEMENT ACT. THE PERMITTEE IS RESPONSIBLE FOR ASSURING THAT ANY FILL MATERIALS OBTAINED FROM OR DISPOSED DURING CONSTRUCTION AND/OR REMEDIATION ACTIVITIES SHALL BE MANAGED IN ACCORDANCE WITH THE SOIL WASTE MANAGEMENT ACT. THE PERMITTEE IS RESPONSIBLE FOR ASSURING THAT ANY FILL MATERIALS OBTAINED FROM OR DISPOSED DURING CONSTRUCTION AND/OR REMEDIATION ACTIVITIES SHALL BE MANAGED IN ACCORDANCE WITH THE SOIL WASTE MANAGEMENT ACT.
- FOR CONTAMINATED SOILS PROPOSED TO ATTAIN REMEDIATION STANDARDS (OUTLINED IN THE LAND RECYCLING AND ENVIRONMENTAL REMEDIATION STANDARDS ACT (ACT 2)) - THE PERMITTEE IS RESPONSIBLE FOR ASSURING THAT THE REMEDIATION FOLLOWS ALL REPORTS/PLANS/PROCEDURES APPROVED BY THE DEPARTMENT'S ENVIRONMENTAL ENGINEER AND BROWNFIELDS (EES) PROGRAM. CONTAMINATED EXPOSURE PATHWAYS AND CONTAMINATED SOILS SHOULD BE PROPERLY MANAGED TO PREVENT GROUNDWATER POLLUTION. THE ACCORDING EES PROGRAM SHOULD BE CONTACTED AT 484.2563860 FOR ANY REMEDIATION QUESTIONS.
- SOILS HAVING ASBESTOS CONTAMINATING MATERIALS (ACM) WILL NEED TO FOLLOW THE ASBESTOS NEARUP REGULATIONS. QUESTIONS ABOUT THE PROGRAM MANAGEMENT OF ACM SHOULD BE DIRECTED TO THE DEP REGIONAL QUALITY PROGRAM AT 484.2563860.
- IF ANY OF THE REQUIREMENTS OR APPROVALS UNDER THE ENVIRONMENTAL CLEANUP AND BROWNFIELDS PROGRAM, SOIL WASTE MANAGEMENT PROGRAM, OR AIR QUALITY PROGRAM REQUIRE MODIFICATIONS, PLEASE CONTACT THOSE PROGRAMS DIRECTLY.
- DEVELOPMENT OF THE SCOPE OF THE PROPOSED REMEDIATION WORK (E.G., REMOVAL OF CONTAMINATED SOILS) IS THE RESPONSIBILITY OF THE APPLICANT, AND THE SCOPE WAS PRESENTED TO THE PREP LAND RECYCLING ACT (LRA) ENVIRONMENTAL CLEANUP AND BROWNFIELDS (EES) PROGRAM THROUGH SUBMITTAL OF A REMEDIATION INVESTIGATION REPORT/CLEANUP PLAN. ANY QUESTIONS WITH REGARD TO THE PROPOSED REMEDIATION SHOULD BE COORDINATED DIRECTLY WITH THE ACT 2/EES PROGRAMS. PLEASE NOTE THAT THE IMPLEMENTATION OF THE MODIFICATION, OR THE RESCUE OF ANY REMEDIATION WORK IS NOT APPROVED OR REVIEWED BY THE REDESIGN CONSTRUCTION STANDARDS PERMITTING PROGRAM.

SEQUENCE OF CONSTRUCTION:

- REMOVABLE SITE CONSTRUCTION
- REMEDIATION SEQUENCE 1:
- AS THIS IS AN ACT 1 (LANDFILL) SITE, THE QUALITY ASSURANCE/QUALITY CONTROL OFFICER (QA/QC) SHOULD BE CONTACTED AND ON-SITE DUESSE AND DISCUSS REMEDIATION ACTIVITIES. THE CONTRACTOR SHALL BE RESPONSIBLE FOR THE REMEDIATION. THE CONTRACTOR SHALL BE RESPONSIBLE FOR THE REMEDIATION. THE CONTRACTOR SHALL BE RESPONSIBLE FOR THE REMEDIATION.
- CONTRACTOR TO NOTIFY THE PROJECT'S ENVIRONMENTAL CONSULTANT IF IMPACTED SOILS ARE SUSPECTED DURING ANY SITE WORK.
- BASED ON THE SITE'S ENVIRONMENTAL DUE DILIGENCE, THE SITE'S SOILS AND/OR GROUNDWATER ARE CONSIDERED CONTAMINATED AS AN ON-SITE EXCAVATION COMMENCES. WITHIN THE CONTAMINATED AREAS FOR REMEDIATION, DRAINAGE AND/OR CONSTRUCTION, THE ENVIRONMENTAL CONSULTANT SHALL OBSERVE THE OPERATIONS FOR ASSURING THAT THE REMEDIATION FOLLOWS ALL SUBMITTED REPORTS/PLANS/PROCEDURES THAT WERE PROVIDED IN ACCORDANCE WITH THE LAND RECYCLING AND ENVIRONMENTAL REMEDIATION STANDARDS ACT (ACT 2) AND/OR APPROVED BY THE DEPARTMENT'S ENVIRONMENTAL ENGINEER AND BROWNFIELDS (EES) PROGRAM.
- PLEASE REFER TO THE ENVIRONMENTAL PLAN FOR PROCEDURES TO MANAGE CONTAMINATED OR POTENTIALLY CONTAMINATED MATERIALS DURING CONSTRUCTION.
- CONTAMINATED SOILS AND/OR WATER ENCOUNTERED DURING CONSTRUCTION AND/OR REMEDIATION ACTIVITIES REQUIRES SPECIAL ATTENTION SUCH THAT ANY CONTAMINATED RUNOFF IS PROPERLY MANAGED AND CONTRACTOR SHOULD NOTIFY THE PROJECT'S ENVIRONMENTAL CONSULTANT. THE ACTIVITY SHOULD CEASE UNTIL CORRECTIVE PROCEDURES AND OPERATIONS CAN BE EMPLOYED TO ELIMINATE THE CONTAMINATION EXPOSURE.
- ALL EARTH DISTURBANCE ACTIVITIES SHALL PROCEED IN ACCORDANCE WITH THE FOLLOWING SEQUENCE. EACH STAGE MUST BE COMPLETED BEFORE ANY FOLLOWING STAGE IS INITIATED. CLEANING AND GRUBBING SHALL BE LIMITED ONLY TO THOSE AREAS DESCRIBED IN EACH STAGE. EROSION AND SEDIMENTATION CONTROL MEASURES AND EARTH MOVING ACTIVITIES WILL BE STOPPED AS FOLLOWS:
- AT LEAST 7 DAYS BEFORE STARTING ANY EARTH DISTURBANCE ACTIVITIES THE OPERATOR SHALL NOTIFY THE CONTRACTOR INVOLVED IN THESE ACTIVITIES INCLUDING BUT NOT LIMITED TO THE LANDOWNER, APPROPRIATE MUNICIPAL OFFICIALS, THE EROSION AND SEDIMENTATION CONTROL PLAN PREPARED, THE LICENSED PROFESSIONAL RESPONSIBLE FOR PREPARATION OF THE PA ACT 2 PLAN DOCUMENTS (LEFTY CHRISTOPHER, P.C. 484-491-6112), OR OTHER QUALIFIED ENVIRONMENTAL PROFESSIONAL (CEP) AND A REPRESENTATIVE FROM THE CHESTER COUNTY CONSERVATION DISTRICT FOR AN ON-SITE PRE-CONSTRUCTION MEETING.
  - 72 HOURS PRIOR TO ANY SOIL DISTURBANCE, CONTRACTOR SHALL CONTACT THE CHESTER COUNTY SOIL CONSERVATION DISTRICT AT MILLDALE TOWN CENTER, 688 UNKNOWNLE ROAD, SUITE 200, HONNETT SQUARE, PA 15488, (610) 455-1360.
  - CESSATION OF ACTIVITY FOR FOUR (4) DAYS OR LONGER WILL REQUIRE TEMPORARY STABILIZATION.
  - INSTALL STABILIZED ROCK CONSTRUCTION ENTRANCE AS SHOWN AND DETAILED ON THE PLANS. THE ENTRANCE WILL BE CONSTRUCTED AND MAINTAINED AS DESCRIBED ON THE EES CONTROL PLAN DRAWINGS. FOR THE INITIAL PHASE 1 SITE REMEDIATION, THE EXISTING DRIVE SHALL BE UTILIZED FOR ACCESS TO LIMIT THE AMOUNT OF LAND DISTURBANCE UNTIL THE REMEDIATION IS COMPLETE AND THE REMAINDER OF SITE CONSTRUCTION CAN COMMENCE.
  - PROJECT SURVEYOR SHALL STAKEOUT AERIAL LIMITS AND DEPTHS OF IMPACTED SOIL.
  - STAKE LIMITS OF DISTURBANCE IN THE FIELD PRIOR TO CLEARING OF ANY EARTH DISTURBANCE. ANY CHANGE OR ENCROACHMENT ONTO THESE AREAS WITHOUT CONSENTATION FROM THE CONTRACTOR AND APPROVAL MAY REQUIRE THE CONTRACTOR TO CEASE DISTURBANCE AND OBTAIN AN EARTH DISTURBANCE PERMIT. INSTALL ORANGE CONSTRUCTION FENCING AROUND IMPACTED AREAS AS SHOWN ON THE PLANS TO PROTECT FROM CONTACT.
  - INSTALL THE PERMITS COMPOST FILTER SOCK DOWNGRADIENT OF REMEDIATION AREAS AS SHOWN ON THE PLANS AND AS DIRECTED BY THE CONSERVATION DISTRICT. MAINTAIN THOROUGH CARE. MEASURES UNTIL PERMANENT COVER IS ESTABLISHED. THE CONTRACTOR WILL INSTALL THE SYSTEMS IN CONFORMANCE WITH THE DETAILS AND MANUFACTURER'S SPECIFICATIONS.
  - ALL EROSION AND SEDIMENT CONTROLS MUST BE COMPLETELY CONSTRUCTED AND STABILIZED PRIOR TO DISTURBANCE OF THE TERRITORY TO THEM.
  - ANY DISTURBED OR REGRADED AREAS HAVING A FINAL GRADE OF THIRTY THREE PERCENT (33%) OR GREATER SHALL BE STABILIZED IMMEDIATELY. DURING GRADING ACTIVITIES, THESE AREAS SHALL BE IMMEDIATELY LINED WITH A STABILIZING EROSION CONTROL BLANKET (ECB) (EAST COAST EROSION BLANKETS TYPE EES-3 OR APPROVED EQUAL) PRIOR TO TEMPORARY SEEDING. ECB SHALL BE INSTALLED PER MANUFACTURER'S SPECIFICATIONS.
  - BEFORE EXCAVATION OF IMPACTED SOIL, SOIL EXCAVATION SHALL BE CONDUCTED IN ALIGNMENT WITH THE ENVIRONMENTAL PLAN. EXCAVATED SOIL SHALL NOT BE REMOVED OR REUSED WITHOUT PRIOR APPROVAL FROM THE DEP. SOILS PROPOSED FOR EXPORT MAY BE STOCKPILED ON SITE IN AREAS DESIGNATED BY THE DEP. PENDING CHARACTERIZATION THESE SOILS SHALL BE CLEARLY LABELED AND COVERED BY TARP OR PLASTIC SHEETING. THE PLASTIC SHEETING SHALL BE MAINTAINED ON THE PLASTIC SHEETING THROUGHOUT THE STOCKPILES SHALL BE CLEARLY LABELED AS PENDING CHARACTERIZATION/EXPORT. TO ENSURE THE SOIL IS NOT REUSED ON SITE, UPON APPROVAL FROM THE PERMITTED DISPOSAL FACILITY, THE SOIL SHALL BE LOADED ONTO TRUCKS AND TAKEN FOR DISPOSAL. IN ACCORDANCE WITH THE DEPARTMENT'S SOIL WASTE MANAGEMENT REGULATIONS AT 25 PA CODE 2601 ET SEQ. 2711 ET SEQ. AND 2811 ET SEQ.
  - UPON REACHING THE LIMITS OF THE PROPOSED REMEDIATION AREA (OR AT OTHER TIME DEEMED APPROPRIATE BY THE DEP) CONFRATORY SAMPLES SHALL BE COLLECTED IN ACCORDANCE WITH PENNSYLVANIA LAND RECYCLING AND ENVIRONMENTAL REMEDIATION STANDARDS ACT.
  - IF THE RESULTS OF THE SAMPLING INDICATE THAT THE REMAINING SITE SOILS MEET RESIDENTIAL SWHS, MOVE ONTO STEP 12. OTHERWISE THE EXCAVATION AREA WILL BE ENLARGED TO REMOVE THE IMPACTED SOILS AND ADDITIONAL CONFRATORY SAMPLES SHALL BE COLLECTED. ADDITIONAL BARRIERS SHALL BE INSTALLED IF REQUIRED.
  - ONCE REMEDIATION IS COMPLETE AND ALL CONTAMINATED SOILS HAVE BEEN REMOVED FROM THE SITE, REMOVE TEMPORARY COMPOST FILTER SOCK DOWNGRADIENT OF REMEDIATION AREA AND THE REMAINDER OF SITE CONSTRUCTION CAN BEGIN.

THE CONTRACTOR SHALL HAVE ON SITE AT ALL TIMES AND FOLLOW THE PROCEDURES AND SPECIFICATIONS PROVIDED IN THE APPROVED ACT 1 CLEAN UP PLAN PREPARED BY GEO-TECHNOLOGY ASSOCIATES, INC.

THE SITE HAS KNOWN CONTAMINATION AND IS ENROLLED IN PENNSYLVANIA'S LAND RECYCLING PROGRAM (ACT 2) REFER TO THE REMEDIAL INVESTIGATION REPORT / RISK ASSESSMENT / CLEANUP PLAN (RI/CP), REVISED DECEMBER 17, 2021, PREPARED BY GEO-TECHNOLOGY ASSOCIATES FOR ENVIRONMENTAL SITE CHARACTERIZATION INFORMATION AND PROPOSED REMEDIAL ACTIVITIES.

EROSION CONTROL LEGEND

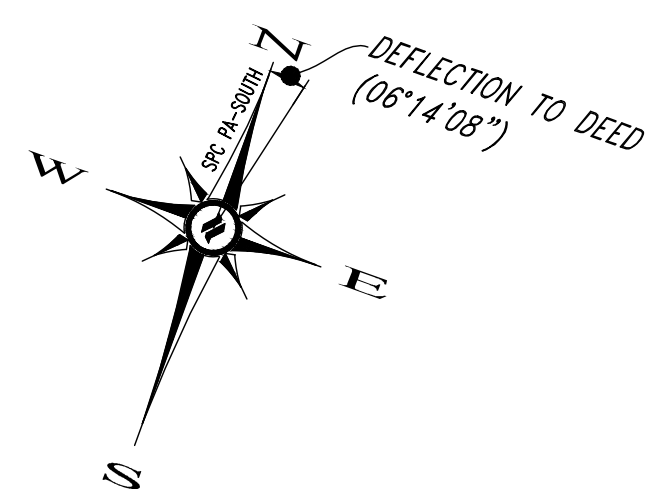
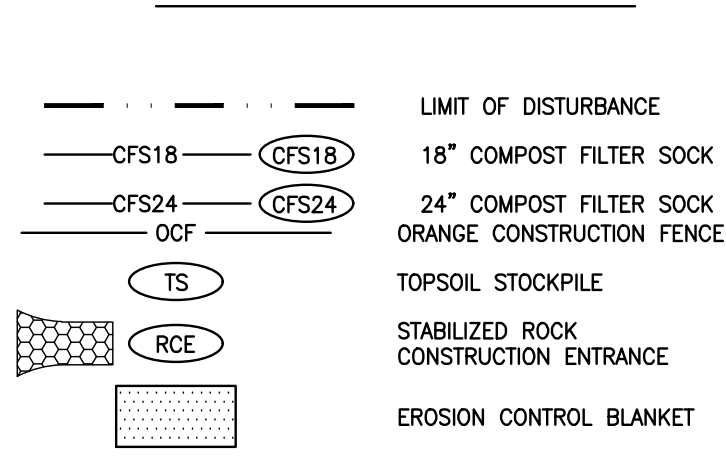

THE PURPOSE OF THIS PLAN IS FOR A FIELD CHANGE INVOLVING THE MINOR ADJUSTMENT TO THE SEQUENCE OF CONSTRUCTION FOR STAGE 1 OF SITE CONSTRUCTION. FULL SEDIMENT BASIN INSTALLATION WILL BE SHIFTED TO THE BEGINNING OF STAGE 2 TO ALLOW SITE REMEDIATION TO OCCUR WITH A MINIMAL AMOUNT OF EARTH DISTURBANCE.

ALL ITEMS DEPICTED ON THIS PLAN IN RED ARE BEING AUTHORIZED BY DEP'S ENVIRONMENTAL CLEANUP PROGRAM. BASIN CONSTRUCTION AND PERIMETER CONTROLS ARE BEING AUTHORIZED UNDER THE NPDES CONSTRUCTION PERMIT.

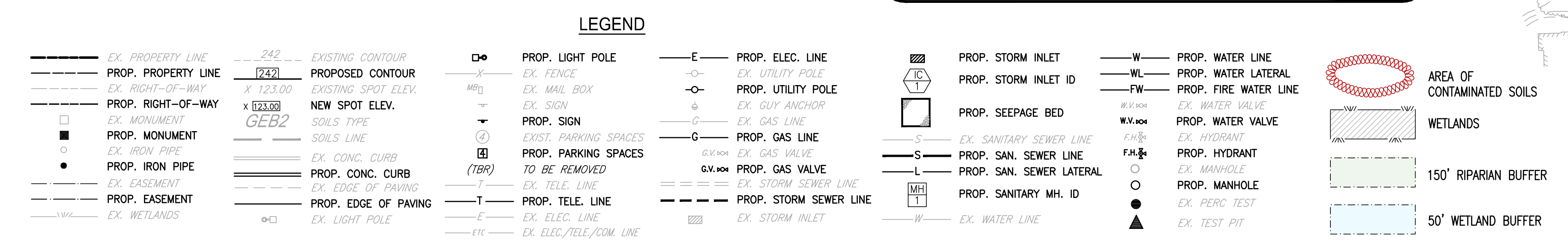
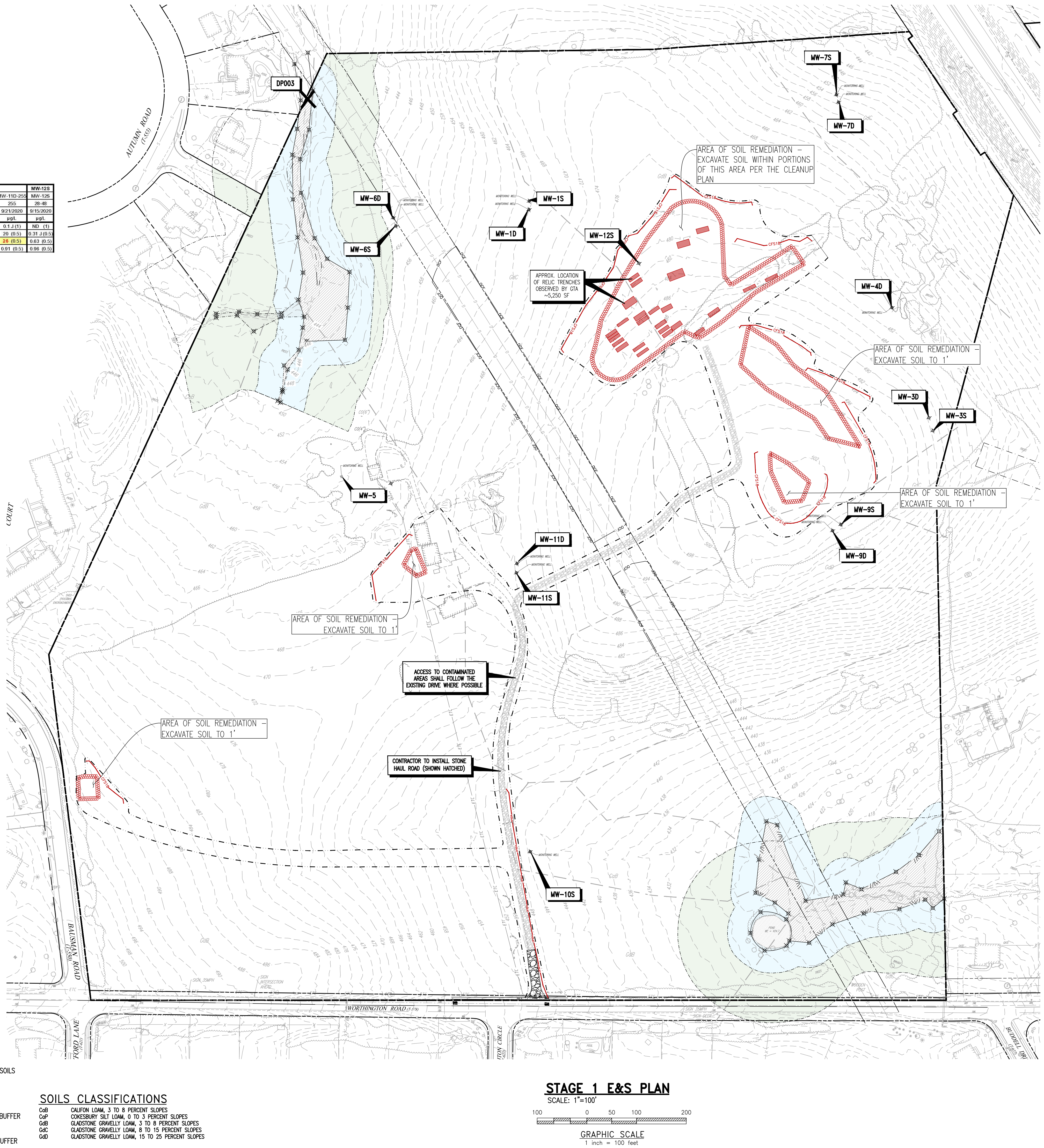

SOILS CLASSIFICATIONS  
 C6B CALSON LOW 3 TO 8 PERCENT SLOPES  
 C6P COCKEYBURY SET LOW, 0 TO 3 PERCENT SLOPES  
 G6B GLAUCONITE GRAVELLY LOAM, 3 TO 8 PERCENT SLOPES  
 G6C GLAUCONITE GRAVELLY LOAM, 8 TO 15 PERCENT SLOPES  
 G6D GLAUCONITE GRAVELLY LOAM, 15 TO 25 PERCENT SLOPES

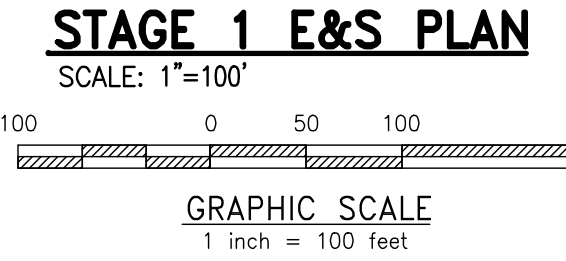

Civil Engineering  
 Land Planning  
 Environmental  
 www.DLHowell.com

1250 Wrights Lane  
 West Chester, PA 19380  
 Phone: (610) 918-9002  
 Fax: (610) 918-9003

NO.	DESCRIPTION
1	
2	
3	
4	
5	
6	
7	